

环保物料

Specifications:

Voltage Rating : 250V AC/DC
 Current Rating : 7A AC,DC
 Withstand Voltage : 1500V AC/minute
 Contact Resistance : 20mΩ(MAX.)
 Insulation Resistance : 1000V DC/1000MΩ(MIN.)
 Temperature Range : -40°C~+120°C

43501W90-2XNP*-B3-**

43501W91-2XNP*-B3-**

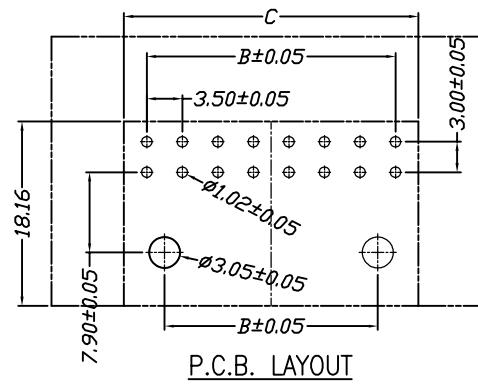
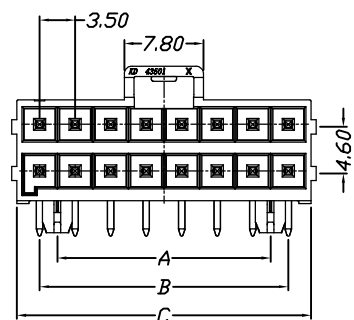
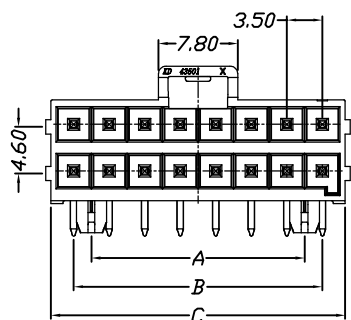
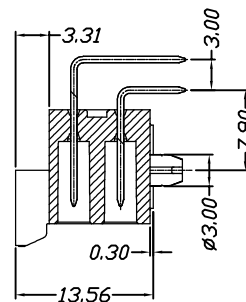
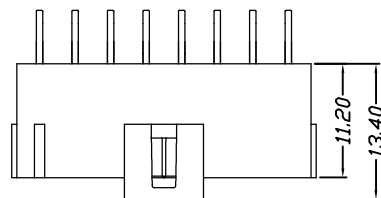
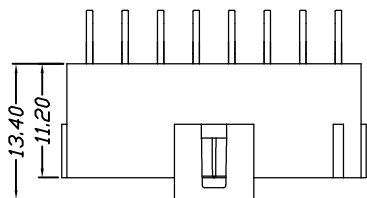

Part No	Dimensions		
	A	B	C
2*2P	—	3.50	8.00
2*3P	—	7.00	11.50
2*4P	7.00	10.50	15.00
2*5P	10.50	14.00	18.50
2*6P	14.00	17.50	22.00
2*7P	17.50	21.00	25.50
2*8P	21.00	24.50	29.00

Material	Color	PIN Material
LCP,UL94V-0	Black	Brass

				GENERAL TOLERANCES		SCALE: 1:1	NAME	DATE
				LINEAR	ANGLES			
			0.0±0.35	X° REF±6°		APPROVED		
AO	新图面发行	2018.7.28	UNIT: MM	0.00±0.25	X° ±3°	DESIGNER		
REV.	REVISION RECORD	DATE	SIZE: A4	0.000±0.15	X° X'±2°	DRAWN	肖坤权	2018.7.28

康导新能源
 网址: www.dgconne.com 电话: 0769-85337633
 邮箱: 2850175986@qq.com 传真: 0769-85392827

TITLE: **3.50mm pitch Dual Wafer**

PART NO:	43501W9*-2XNP*-B3-**	
DWG. NO:	ENDE05	
REV:	AO	SHEET: 1/1