

环保物料

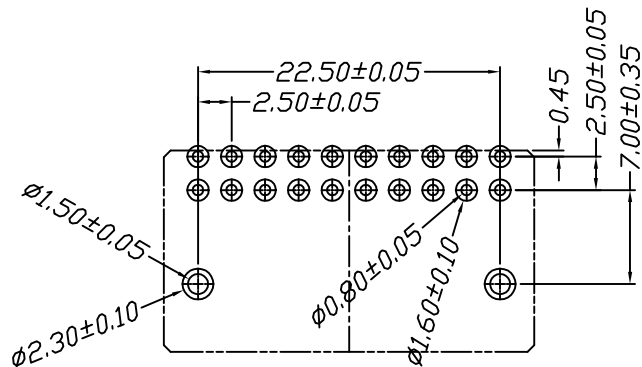
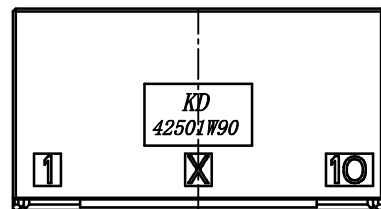

P.C.B. LAYOUT

Specifications:

Voltage Rating : 250V AC/DC
 Current Rating : 5A AC,DC
 Withstand Voltage : 1500V AC/minute
 Contact Resistance : 40mΩ(MAX.)
 Insulation Resistance : 1000V DC/1000MΩ(MIN.)
 Temperature Range : -55°C~+105°C

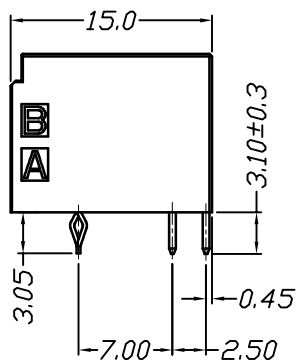
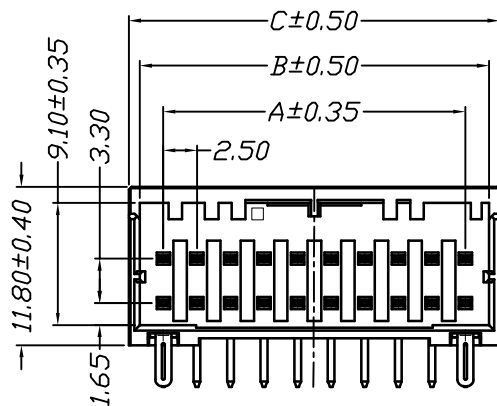
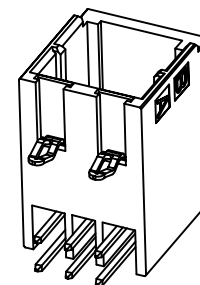

Part No	Dimensions		
	A	B	C
2*10P	22.5	26.0	27.6
2*8P	17.50	21.00	22.6
2*6P	12.5	16.0	17.6
2*5P	10.00	13.50	15.10
2*4P	7.5	11.0	12.6
2*3P	5.0	8.5	10.1
2*2P	2.5	6.0	7.6

Material	Color	PIN Material	Stator Material
PBT,UL94V-0	Black	Brass/Gold 3U"	Brass/Tin-plated

				GENERAL TOLERANCES		SCALE:	NAME	DATE
				LINEAR	ANGLES	1:1		
				0.00±0.35	X° REF±6°	APPROVED		
AO	新图面发行	2018.7.28	UNIT: MM	0.00±0.25	X° ±3°	DESIGNER		
REV.	REVISION RECORD	DATE	SIZE: A4	0.000±0.15	X° X'±2°	DRAWN	肖坤权	2018.7.28

康导新能源
 网址: www.dgconne.com 电话: 0769-85337633
 邮箱: 2850175988@qq.com 传真: 0769-85392827

PART NO:	42501W90-2*NPA-A1-**	
DWG. NO:	ENDE05	
REV:	A0	SHEET: 1/1