

环保物料

Specifications:

Contact resistance: $\leq 20m\Omega$
 Insulation resistance: $\geq 1000M\Omega$
 Rated voltage: 250V AC DC
 Rated current: 5.0A AC DC
 Withstand Voltage: 1000V AC/minute
 Temperature Range: $-25^{\circ}C \sim +85^{\circ}C$
 Housing: LCP UL94V-0, BLACK
 Contacts: Brass/MATTE Sn-plated
 Solder Tabs: Brass/MATTE Sn-plated
 CAP: Stainless steel

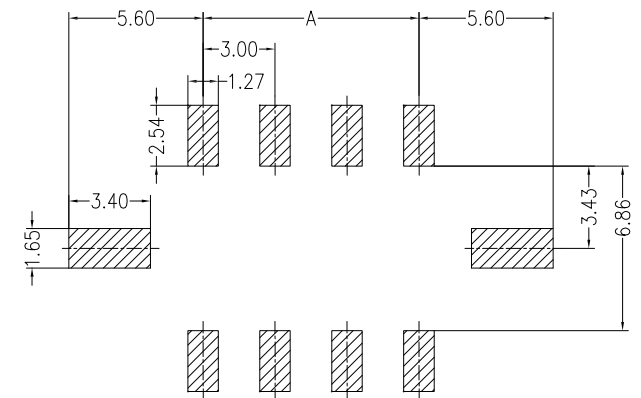
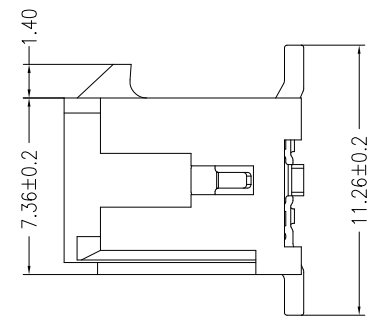
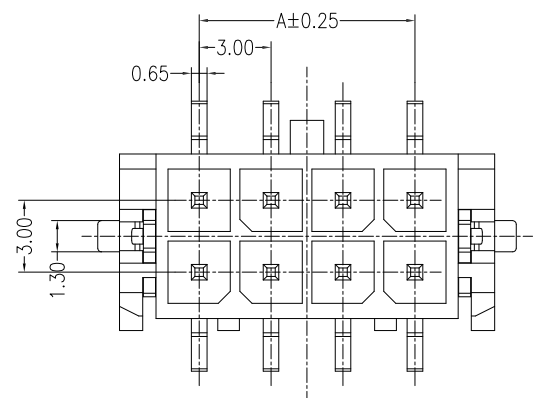
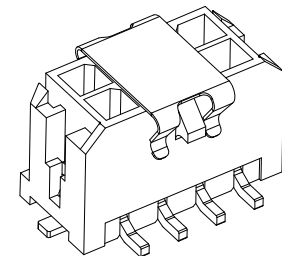
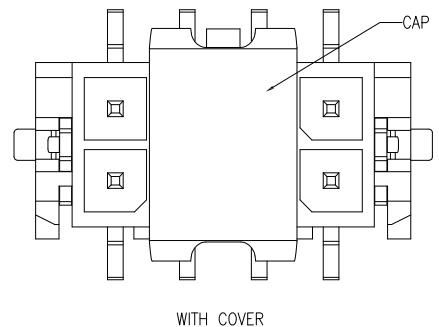
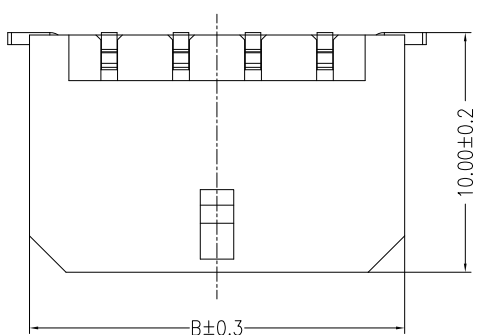

PIN	DIM A	DIM B
2x1		6.65
2x2	3.00	9.65
2x3	6.00	12.65
2x4	9.00	15.65
2x5	12.00	18.65
2x6	15.00	21.65
2x7	18.00	24.65
2x8	21.00	27.65
2x9	24.00	30.65
2x10	27.00	33.65
2x11	30.00	36.65
2x12	33.00	39.65

PCB LAYOUT(Tolerance: ± 0.05)

				GENERAL TOLERANCES		SCALE:	NAME	DATE	 <p>康导新能源 网址: www.dgonns.com 电话: 0769-85337633 邮箱: 2850175986@qq.com 传真: 0769-85392827</p>	PART. NO:	
				LINEAR	ANGLES	1:1	黎腾	2017.06.16		23002AWV	
				0.0 \pm 0.35	X° REF \pm 6°	APPROVED	肖坤权	2017.06.16		DWG. NO:	
A0	新图面发行	2017.06.16	UNIT: MM	0.00 \pm 0.25	X° \pm 3°	DESIGNER	旷淇	2017.06.16		REV: A0 SHEET: 1/1	
REV.	REVISION RECORD	DATE	SIZE: A4	0.000 \pm 0.15	X° X' \pm 2°	DRAWN					