

环保物料

Specifications:

Contact resistance: $\leq 20m\Omega$
 Insulation resistance: $\geq 1000M\Omega$
 Rated voltage: 250V AC DC
 Rated current: 5.0A AC DC
 Withstand Voltage: 1000V AC/minute
 Temperature Range: $-25^{\circ}C \sim +85^{\circ}C$

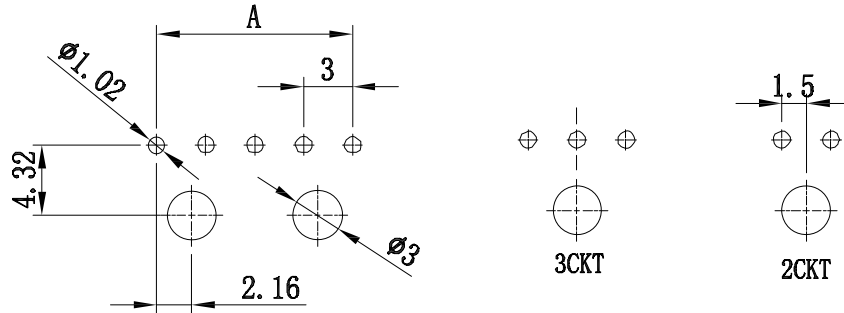
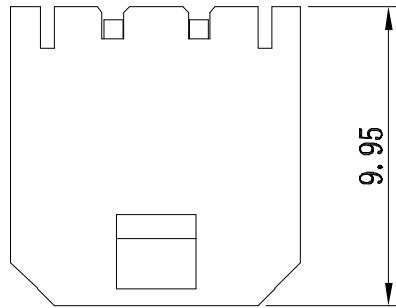

P. C. B LAYOUT

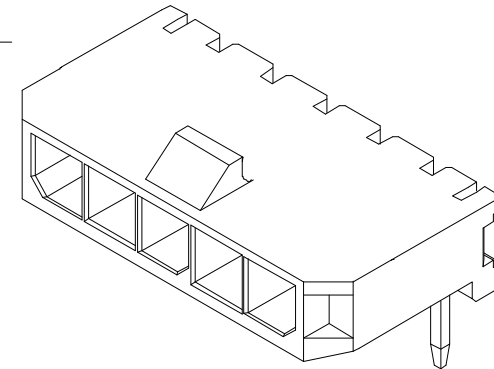
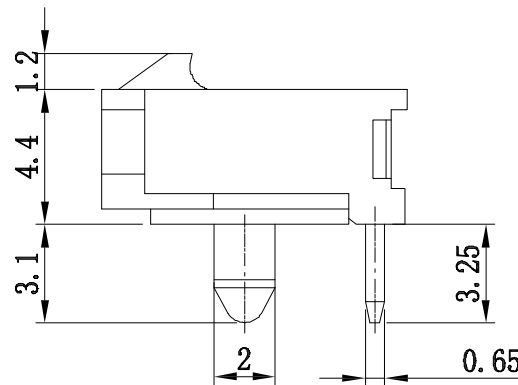
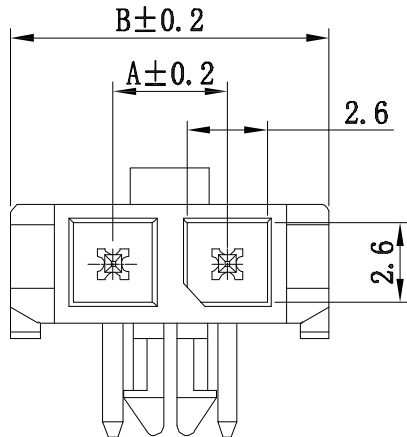

Poles	Dimensions mm	
	A	B
2	3.00	9.65
3	6.00	12.65
4	9.00	15.65
5	12.00	18.65
6	15.00	21.65
7	18.00	24.65
8	21.00	27.65
9	24.00	30.65
10	27.00	33.65
11	30.00	36.65
12	33.00	39.65

序号	图号	名称	材料	数量	附注
2		Contact	Brass Tin	N	
1		Housing	PA9T (UL94V-0)	1	Black

GENERAL TOLERANCES		SCALE:	NAME	DATE	康导新能源 www.dgconne.com 电话: 0789-88337833 网址: 2850175988@qq.com 传真: 0789-88392827	PART. NO: 23001AW			
LINEAR	ANGLES	1:1	APPROVED	黎腾			2017.06.16		
0.00 ± 0.35	X° REF ± 6°		DESIGNER	肖坤权 <td>2017.06.16 </td>			2017.06.16		
0.00 ± 0.25	X° ± 3°		DRAWN	旷洪 <td>2017.06.16 </td>			2017.06.16		
REV.	REVISION RECORD	DATE	UNIT: MM	SIZE: A4	0.000 ± 0.15	X° X' ± 2°	TITLE: 3.00mmPITCH 90° WAFER DIP TYPE	REV: A0	SHEET: 1/1