

环保物料

Specifications:

Contact resistance: $\leq 20m\Omega$
 Insulation resistance: $\geq 1000M\Omega$
 Rated voltage: 250V AC DC
 Rated current: 2.0A AC DC
 Withstand Voltage: 1000V AC/minute
 Temperature Range: $-25^{\circ}C \sim +105^{\circ}C$
 Housing: LCP/PA9T UL94V-0,
 Contacts: Brass/Sn or Matte Sn-plated
 Solder Tabs: Phosphor Bronze/Sn or Matte Sn
 or GOLD-plated

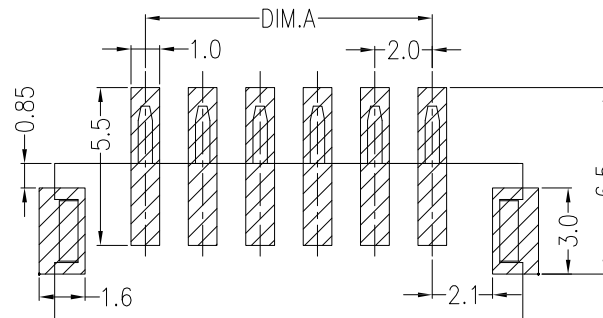
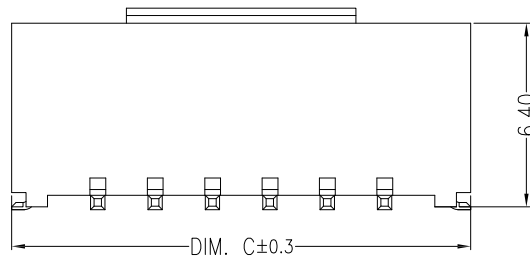
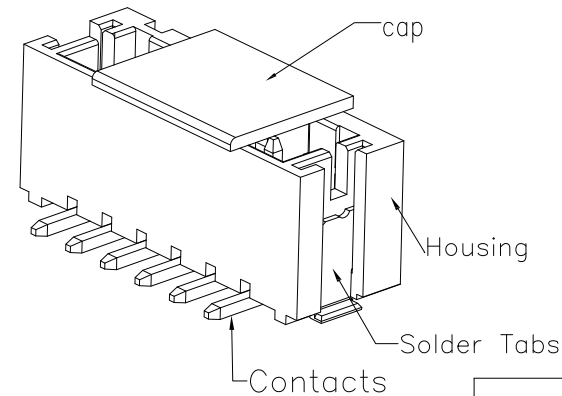
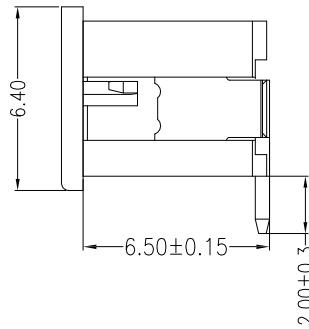
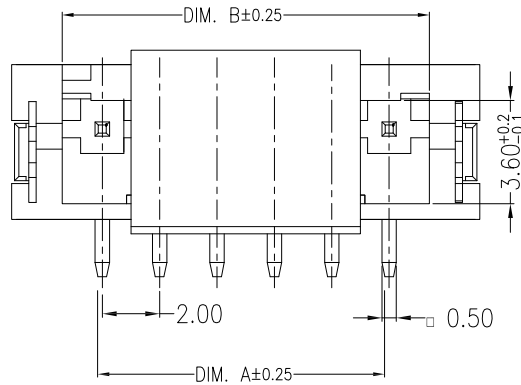

SUGGESTED PCB LAYOUT

Circuits	Dimensions (mm)		
	DIM. A	DIM. B	DIM. C
02	2.00	4.80	8.00
03	4.00	6.80	10.00
04	6.00	8.80	12.00
05	8.00	10.80	14.00
06	10.00	12.80	16.00
07	12.00	14.80	18.00
08	14.00	16.80	20.00
09	16.00	18.80	22.00
10	18.00	20.80	24.00
11	20.00	22.80	26.00
12	22.00	24.80	28.00
13	24.00	26.80	30.00
14	26.00	28.80	32.00
15	28.00	30.80	34.00
16	30.00	32.80	36.00

				GENERAL TOLERANCES		SCALE: 1:1	NAME	DATE	康导新能源 网址: www.dgonne.com 电话: 0769-85337633 邮箱: 2850175988@qq.com 传真: 0769-85392827	PART. NO: 22001AWV	
				LINEAR	ANGLES					APPROVED	黎腾
A0	新图面发行	2017.06.16		0.0 ± 0.35	X° REF ± 6°	DESIGNER	肖坤权	2017.06.16		REV: A0	SHEET: 1/1
REV.	REVISION RECORD	DATE	SIZE: A4	0.00 ± 0.25	X° ± 3°	DRAWN	旷淇	2017.06.16	TITLE: 2.00mm PITCH 180° WAFER SMT TYPE		